

ARGUS LIGHT s. r. o.
Production and sale of lights

USER MANUAL FOR LED LIGHT
Technical parameters

type	A (mm)	B (mm)	C (mm)	light color /luminosity	power
9005	351	35	78	4000K / 350 lm	5 W
9010	579	35	78	4000K / 700 lm	10 W
9015	911	35	78	4000K / 1100 lm	15 W

230 V – 50 Hz – LEDs 2835 SMD protection IP 20 – class I



Important warning

- follow the instructions that are stated in this manual exactly, do not change the function and design of the light, in the case of a non-functioning or damaged light or its unusual function, talk to an expert, do not use the damaged light
- the light is intended only for indoor residential use only on solid wooden surfaces or on walls
- use the light source only up to the maximum power that is stated on the light
- the light is not designed for a connection with a dimmer
- the light has an LED light source, avoid long-term direct eye contact with the spot LED sources
- do not disassemble the light or open the cover of the diodes, LED light sources are not replaceable
- if there is any dirt, clean the light when it is switched off and use only products, that do not damage the looks and function of the light
- maintenance and fixing needs to be done in accordance with safety standards
- the manufacturer is not liable for damages and defects that have been caused by improper use of the light
- mounting and connecting to electricity needs to be done by an expert, in the case of a non-expert connecting, you are in a danger of an electric shock
- all electrical connections need to be properly fixed
- the product is marked with a conformity mark 
- the lights can't be touched by any flammable objects and the lights can't be covered by anything, don't allow any grease or fat on the light
- the distance between the glass of the uncovered bulb needs to be the same for all lights from the directly illuminated surface at least 0,3 mm, unless stated differently
- when connecting or different action with the light, always disconnect the power cord from the socket or turn off the circuit breaker
- when a fault is detected in the light, disconnect the power cord from the socket or turn off the circuit breaker, do not operate the light anymore
- connect the lights accordingly to the applicable regulations for first and second class lights
- the sustainability of the use of lights at given environment and on basis is determined by the designer or inspection technician
- don't place any sources of water vapor near the lights (humidifier, stove, etc.), don't use the light in an environment with high temperature or high humidity or there will be a risk of destruction on the light
- operate in an electrical network with parameters of 220 – 240 V 50 Hz
- the light includes a non-replaceable light source
- the light is not a kid's toy, it is a decorative item, it does not belong into kids' hands
- keep the plastic light packaging away from kids, they are not toys and there is a risk of suffocation

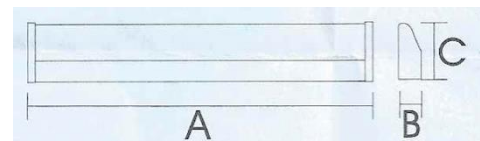

Cleaning the lights

-before starting with the cleaning, disconnect the power cord from the socket, for a solidly installed light, turn off the circuit breaker

-don't clean the lights with rough and sharp products, we recommend using a slightly wet cloth in clean water

Warning: Any action or activity with the light that is contrary to the object of its use (as a light) IS NOT ALLOWED and is a reason for non-recognition of a complaint or caused damages.

WARNING!!!

IN THE CASE THAT ANY MODIFICATION, SUCH AS MAKING A HOLE, CUT-OUT, ADDITIONAL WIRING, ETC., IS DONE TO THE LIGHT, THE LIGHT IS NOT A SUBJECT TO CLAIMS BY REPLACEMENT, BUT IT WILL BE REPAIRED WITHIN THE PERIOD DETERMINED AFTER AGREEMENT WITH THE CONSUMER.

Connection scheme:

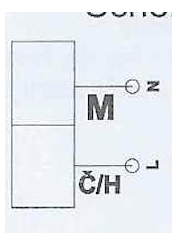

Lights of class II

Color indication of wires:

Č/H – black, brown

M – blue

Connection scheme:

Lights of class II

Color indication of wires:

Č/H – black, brown

M – blue

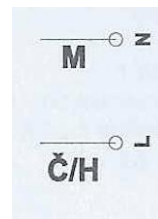

Warning!

Does not contain a terminal block.

Connecting can be requested from a qualified person.

Mounting of the light

Follow the steps in the pictures and comments.

Do not connect the LED light to an electrical voltage source before the light installation is fully done, the light is screwed with two screws mounted through the mounting holes in the light.

Make the exact matching holes in the wall and install the screws with the help of dowels, leaving the screws in the position corresponding to the dimension of the mounting holes of the light. Plug in the power cable, make sure that the cables are plug in correctly. And make sure that the light attachment is stable.

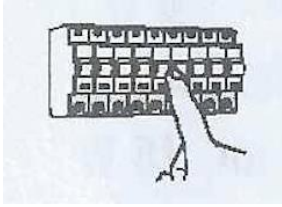

1. Before mounting, disconnect the power cord from the socket or turn off the circuit breaker.

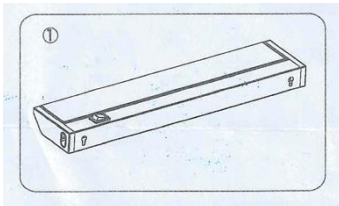

2. Do a completeness check according to the picture number 1.

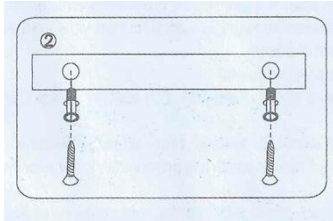

3. Drill holes into the wall according to the dimensions in the light.

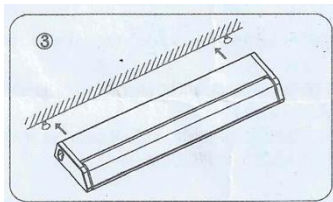

4. Insert and fasten the light to the wall using dowels and screws.

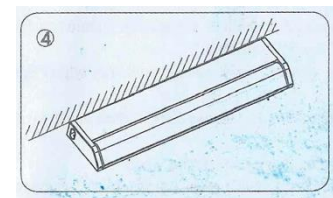

5. Make sure that the stability and strength of the attached light are right, check the correctness of the cable connection and light functionality.

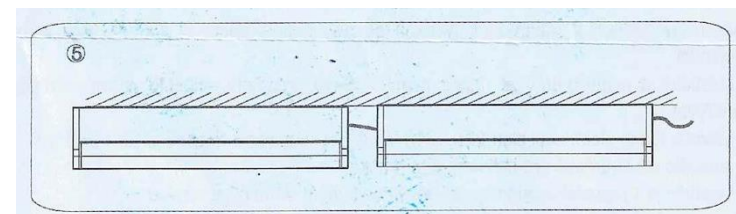

6. In the case of series connection of the lights, make the attaching according to the procedure mentioned above for each of the lights, the maximum number of connected lights of the same type is 20 pcs.



7. Do not install the light into a wet, dusty environment, do not cover the light and do not interfere with the internal wiring of the light in any way!